

TECHNICAL DATA SHEET

Product Name	Gas Ball valve With Yellow Lever
Standard	EN 331
Certificate	DVGW approval
Working Temperature	-20°C/+100°C
Pressure Class	MOP 5 /PN10
Intended Use	Industrial Application
Connection type(s) and size(s)	Threaded Rp EN 10226-1

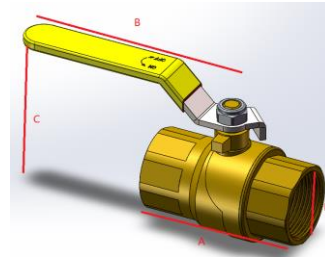

Part Name	Material	Surface
Body	Brass(CW617N)	Nickel
Bonnet	Brass(CW617N)	Nickel
Ball	Brass(CW617N)	Nickel-Chrome
Seat	PTFE	
Stem	Brass(CW617N)	
Stem Seal	NBR	
Packing	Graphite	
Gland Nut	Brass	
Yellow Handle	Q235 Steel with Chrome Plating	
Screw	Brass	

SIZE	DIMENSIONS						Weight/g
	D1 -Thread	D2 -Thread	A	B	C	D	
1/2"-DN15	Rp1/ 2	Rp1/ 2	58	89	42	15	203
3/4"-DN20	Rp3/ 4	Rp3/ 4	67	89	46	20	301
1"-DN25	Rp1	Rp1	80,8	112	60	25	493
1 1/4"-DN32	Rp1 1/ 4	Rp1 1/ 4	94,5	131	69,5	30,5	758
1.1/2"-DN40	Rp1 1/ 2	Rp1 1/ 2	103	131	72	38,5	1010
2"-DN50	Rp2	Rp2	126	159,5	83	47,5	1762

INSTALLATION and OPERATING INSTRUCTION

- 1- Do not unpack the valve until installation to prevent falling of any unwanted substance that may affect the working of valve.
- 2- Take measures against any possible damage that may occur during transport and shipment.
- 3- Clean away every unwanted substance in your system before installation.
- 4- Valve should be off position while installing.
- 5- Be careful that the thread length of the part that will be installed to the valve will not be too longer or too shorter than the thread length of the valve.
- 6- While installing, grab the valve by the appropriate tool from the across flats where you'll install it.
- 7- During installation do not use excessive adhesive or any unsuitable substance.
- 8- Use the valve fully open or fully closed position.
- 9- Do not paint the valve. Do not expose the valve with abrasive chemicals.
- 10- Do not use any other tools for opening or closing the valve and do not remove the handle.
- 11- In case of any damage or disorder, valve should be changed by authorities.
- 12- Complying with the installation and usage instruction is compulsory. Otherwise, the product will be cut of guarantee.
- 13- Do not forget to get the document of guarantee. This document is valid only with the related bill