

# STG-900-KIT-B / STG-900

This top-quality, long-range system is specially designed for synthetic turf sports field irrigation.

## KEY BENEFITS

- Arc setting: 40° to 360°
- QuickCheck™ Arc Mechanism
- Through-the-top arc adjustment
- Water-lubricated gear drive
- Factory-installed rubber logo cap
- Nozzle trajectory: 22.5°

## OPERATING SPECIFICATIONS

- Radius: 31.4 m to 36.6 m
- Flow: 16.9 to 20.9 m<sup>3</sup>/hr; 282 to 348 l/min
- Operating pressure range: 6.9 to 8.3 bar; 690 to 830 kPa
- Precipitation rate: 35 mm/hr approximately
- Warranty period: 5 years for component parts

## USER-INSTALLED OPTIONS

- Rubber Cover Kit STG-900: P/N 473900SP



### STG-900\*

Overall height: 36 cm  
Pop-up height: 8 cm  
Diameter: 20 cm  
Inlet size: 1½" (40 mm) Acme

\*For use with the ST-173026-B Vault

## STG-900-KIT-B

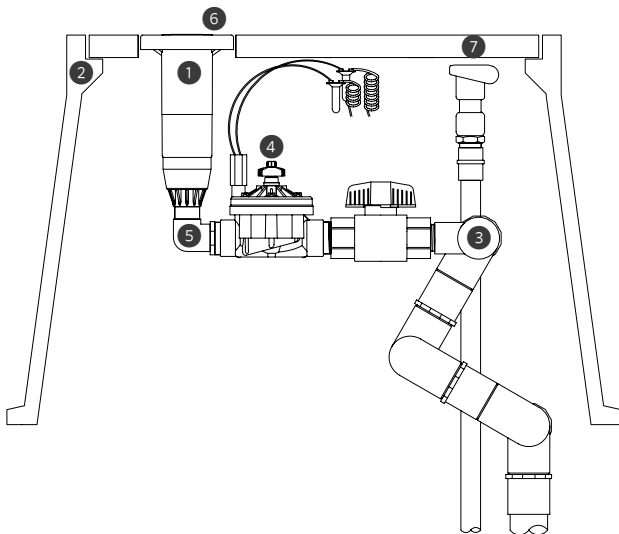

### STG-900-KIT-B COMPONENTS

FIGURE	COMPONENTS	QTY	DESCRIPTION
1	STG-900-83	1	Pop-up, top serviceable, adjustable arc (40°–360°), 1½" (40 mm) Acme inlet
2	ST-173026-B	1	Composite vault, pre-cast hole for rotor and quick coupler
3	ST-2008-VA	1	Vertical alignment PVC Swing Joint, seven pivot points, 2" (50 mm) female slip inlet, 1½" (40 mm) female Acme outlet
4	ST-VBVF-K	1	ICV-151G valve, manifold ball valve, 1½" (40 mm) Acme inlet, 1½" (40 mm) Acme outlet
5	239800	1	1½" (40 mm) elbow, female Acme to male Acme, connects STG-900 rotor to ST-VBVF-K
6	473900SP	1	STG-900 rubber cover kit
7	HQ-5-RC-BSP	1	Quick coupler, 1" BSP inlet, 1¼" outlet for key

STG-900 Rotor



STG-900 NOZZLE PERFORMANCE DATA

Nozzle	Pressure		Radius m	Flow		Precip mm/hr	
	bar	kPa		m <sup>3</sup> /hr	l/min	■	▲
73 ●	7.0	700	31.4	16.9	282	34.3	39.6
	7.5	750	33.2	17.5	291	31.7	36.6
Orange	8.0	800	35.1	18.1	301	29.4	34.0
83 ●	7.0	700	34.1	19.1	319	32.8	37.9
	7.5	750	35.4	20.0	333	32.0	37.0
Tan	8.0	800	36.6	20.9	348	31.2	36.1

Notes:

All precipitation rates are calculated for 180° operation.  
For the precipitation rate of a 360° sprinkler, divide by 2.

Requires minimum 7.0 bar; 700 kPa dynamic pressure supplied to the Swing Joint inlet.

ST SWING JOINTS

Multiaxis 22 bar; 2,200 kPa rated vertical alignment PVC Swing Joints with seven O-ring sealed pivot points allow the rotor to be perfectly placed within the ST Vault's cover set opening.

**ST-2008-VA:** 2" (50 mm) for STG-900

**Inlet:** 2" (50 mm) slip\*  
**Outlet:** 1½" (40 mm) Acme

\*Use P/N 241400 adapter to connect to male BSP threads

**Adapter fitting 239300**  
Connects 239800 elbow fitting to STG-900 Rotor with Acme inlet



ST VALVE SETS

Heavy-duty control valves are configured to complement the ST Rotors and ST Vaults.

**ST-VBVF-K:** For STG-900-KIT-B

**Valve:** 1½" (40 mm) NPT ICV  
**Ball valve:** 22 bar (2,200 kPa) rating  
**Inlet:** 1½" (40 mm) Acme  
**Outlet:** 1½" (40 mm) Acme

**Low-pressure-loss design:** 0.7 bar; 70 kPa at 22.7 m<sup>3</sup>/hr; 378 l/min from Swing Joint inlet through to rotor  
**Includes:** 1½" (40 mm) connection fittings



ST VAULTS

Heavy-duty tapered fibreglass and polymer-concrete construction with pre-cast holes for rotor and quick coupler valve.

**ST-173026-B for STG-900-KIT-B includes 50 mm thick, 3-piece cover set**

**Main cover:** 43 cm x 76 cm  
**Overall height:** 66 cm  
**Body weight:** 47 kg  
**Total weight:** 73 kg  
**Base pad:** 68 cm x 104 cm  
**Quick-access ports:** 1



① Quick Coupler

All ST Vaults include handy quick-access ports. Quick couplers provide a convenient source of water for washing down spills and water-soluble paint. The integrated in-vault design eliminates the need for additional quick-coupler enclosures.