

COD. 21.11.16

## ELECTROFUSION 90° ELBOW

SDR 11 - PN 16

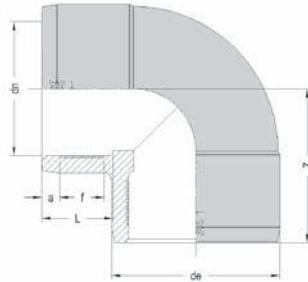

52

## DIMENSIONS

## WEIGHTS

dn	de	L	f	a	Z	
20	34	33	15	10	55	75
25	38	33	15	9	57	80
32	46	39	18	10	75	130
40	56	48	25	11	80	190
50	68	54	27	12	89	300
63	83	52	27	13	104	450
75	97	64	29	18	116	665
90	113	70	37	18	130	855
110	136	76	39	20	146	1325
125	162	79	42	19	152	2130
140	174	85	38	20	166	2700
160	206	89	45	20	180	4050
180	226	116	50	23	215	4800
200	251	118	55	23	229	6450
225	281	120	45	36	251	9330
250	310	127	53	33	272	11600
315	397	145	54	47	321	23000

WELDABILITY ON  
PIPE/FITTING PE 100

dn	SDR 17	SDR 11
20		● ▲
25		● ▲
32	● ▲	●
40	● ▲	●
50	●	●
63	●	●
75	●	●
90	●	●
110	●	●
125	●	●
140	●	●
160	●	●
180	●	●
200	●	●
225	●	●
250	●	●
315	●	●

- weldable only with monovalent welding units Serie Euro
- weldable only with universal ef units
- ▲ minimum weldable thickness 3 mm

– Moulded in PE 100-RC

– Absolutely compulsory the use of aligning clamp for all diameters

– Absolutely compulsory the pipes/fittings scraping