



► **Installs anywhere**

Ideal for installation in a valve box, built to perform reliably in wet, muddy and dirty conditions.

► **Battery powered**

Get more than two years of operation with two 9V batteries.

► **Problem solver**

When it's too costly or inconvenient to run electrical wire to the irrigation valves, install the ESP-9V.

ESP-9V Battery-Operated Controller

Reliable and long lasting.



Get reliable automatic irrigation control, even when you don't have AC power, with the ESP-9V Series Battery-Operated Controller. The ESP-9V operates reliably for more than two years using two 9V batteries.

The ESP-9V was built to be installed virtually anywhere. With a waterproof case and dual-sealed battery compartment, life in a wet, dirty valve box is no problem.

Get the convenience and efficiency of automatic irrigation control with the ESP-9V.

ESP-9V Battery-Operated Controller

The ESP-9V Battery-Operated Controller is tougher, longer lasting and easier to program than competitor's controllers.

Tougher/Longer Lasting

ESP-9V Outlasts Competition

To test the ESP-9V's performance in harsh conditions and compare against other battery-operated controllers, Rain Bird used a new test to simulate the worst possible environment for a controller—life in a flooded valve box at extreme temperatures.

Test Conditions

The controllers were repeatedly submerged in saltwater at alternating extreme hot and cold temperatures for more than four days.

Results

- ESP-9V lasted 70% longer than the competition.
- The dual-sealed battery chamber prevented water intrusion for reliable performance.

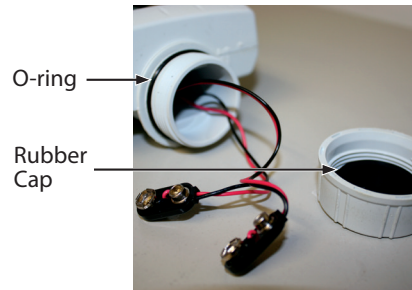

ESP-9V Test Results

- ESP-9V was still operational after four days underwater.
- O-ring and rubber insert keeps water out!

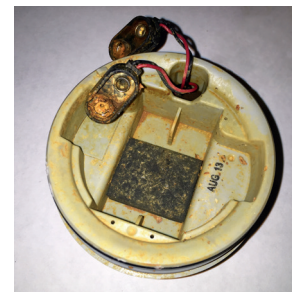

Hunter® Node Test Results

- Node failed in less than two days.
- One o-ring is not enough to keep water out.

Easier to Program

- Large, easy-to-read LCD screen – **85% larger than the Hunter Node.**
- Icons are BIG and easy to understand.
- Create common program schedules in three easy steps.



Controller Features



- Dedicated manual watering button for easy operation.
- One-touch manual watering allows you to start a full irrigation cycle with the touch of a button.
- Non-volatile memory keeps your schedule safe even if batteries are dead.
- Scheduling features: 240 minute duration, 6 start times, and 4 watering day options per zone (custom days, cyclic, ODD, and EVEN).
- Automatic zone-stacking ensures that only one valve irrigates at a time.