

# PE Pressure valve

PE Pressure valve is an unique gate valve, witch is used for water/liquid with small dry matter content. The valve is especially suitable for farming, industry and where rustproof materials are required. Pressure up to 6 bar by 20°C\*\*. The valve is watertight\* for pressure from both sides.

The valve is made in simpel and well tested design. The material is PE 100 virgin-material. This makes static calculations possible and gives possibilities for welding connections.

Pipe ends are mirror welded directly to the valve body.

The valve has 100% troughput, witch make the valve suitable for many puposes.

All valves are factory tested by full working pressure for tightness on the valve body and by the valve gate.

#### Following dimensions are available:

- ⇒ 110 mm
- ⇒ 125 mm
- ⇒ 160 mm
- ⇒ 200 mm
- ⇒ 250 mm

#### Advantages:

- ⇒ 100% virgin-material.
- ⇒ Simple and well tested design.
- ⇒ Factory tested before delivery.
- ⇒ Throughput is smooth and without sharp edges.
- ⇒ Unique non-leak construction by top part with double non-leak barrier.

The valve can also on request be delivered in PP.

A bigger range of accessories are available as extension bar, extension set, spindle and electrical actuator.

## III Fog Agroteknik A/S





## Measurements of PE pressure valves

Dimension (mm)	Pressure	A	B	D1	D2	D3	H1	H2	H3
110	6 bar	110	200	348	68	128	435	40	285
125	6 bar	125	225	350	68	128	465	40	310
160	6 bar	160	252	352	68	128	527	38	329
200	6 bar	200	290	368	68	168	610	37	373
250	6 bar	250	242	404	68	168	718	45	423

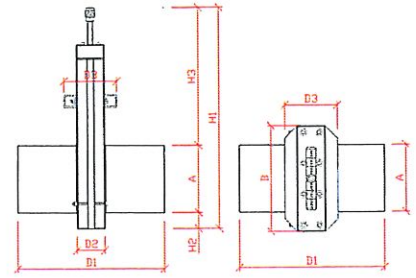

## Accessories

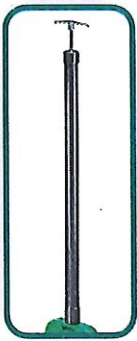

### Extension set for valve.

The extension set is available in 0,5 – 1,0 – 1,5 – 2,0m.

The extension set consists of:

- 50 mm PVC protection pipe.
- Rod of stainless steel.

### Extension set with house for valve.

The extension set with house is available in 0,5 – 1,0 – 1,5 – 2,0m.

The extension set with house consists of:

- 50 mm PVC protection pipe.
- Rod of stainless steel.
- PVC house Ø160 or Ø200mm.
- Top lid of stainless steel with finger hole.

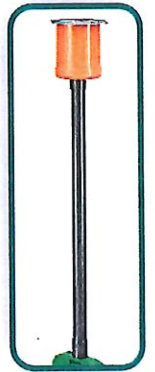

### Spindle for valve.

The spindle extension is made from PVC. The interior is out of stainless steel and the handle is of plastic.

A valve with a spindle is ideal if you do not want to open or close the valve so often, and it is also possible to lock the spindle.

It is very suitable for pressure valves with larger dimensions.

### Electrical actuator for valve.

The entire valve program is also deliverable with electrical actuator.

The actuator is mounted with a stainless steel bracket, inside a 200mm protection pipe.

We supply the valves with following LINAK actuators LA28, LA25 or LA36



\* Class of tightness and pressure test.

Tightness: 1% of acceptable leakage according to DIN 19569-4.

Test is done by max. working pressure and by 20°C. Temperature higher than +40° can reduce the working pressure of the valve.

\*\* Temperatures: PE 100 is suitable for temperatures from -50° +80°C. Recommended working temperature -10° + 40°